

T02-00026-2004 Universal Mounting Kit Installation Instructions

The T02-00026-2004 Universal Mounting Kit allows TM8000 and TM9000 mobile radios to be securely mounted for use in a vehicle.

The Universal Mounting Kit is suitable for high and low power mobile radios.

The Universal Mounting Kit is supplied with:

- lid ①
- mount body ②
- base plate ③
- side brackets with hexagonal screws and washers (x2) ④
- M4x10 hexagonal button screws and washers (x4) ⑤
- M3x6 T8 screws (x8) ⑥
- #10x20 hexagonal Pozidriv screws (x6) ⑦

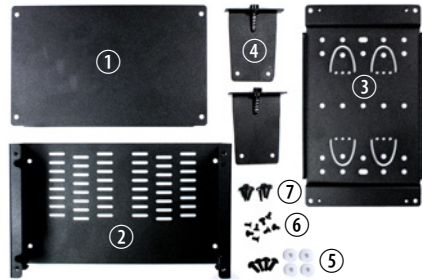

The mounting kit can be fitted to a surface using the base plate, or DIN mounted using the two slotted holes on each side of the mount body (four in total).

The following figures show the two main configurations for the Universal Mounting Kit:

Fitting to a surface
(with base plate)



Fitting inside a DIN slot
(without base plate)



Alert Symbols and Message Conventions

Please follow exactly any instruction that appears in the text as an ‘alert.’ An alert provides necessary safety information as well as instruction in the proper use of the product.

This document uses the following types of alert:



Warning This alert is used when there is a hazardous situation which, if not avoided, could result in death or serious injury.



Caution This alert is used when there is a hazardous situation which, if not avoided, could result in minor or moderate injury.

Notice This alert is used to highlight information that is required to ensure procedures are performed correctly. Incorrectly performed procedures could result in equipment damage or malfunction.



This icon is used to draw attention to information that may improve understanding of the equipment or procedure.

Selecting the Mounting Position



Warning When mounting inside a vehicle, ensure the equipment is secure. Unsecured equipment is dangerous to the vehicle occupants.



If unsure about the mounting position, assemble the mount with the radio first (as described in “[Installation](#)” on page 4) and try out different mounting positions. The mount needs to be in a disassembled state for installation.

Before installation, make sure that the mounting position meets the following criteria:

- There is enough clearance for both mount and radio to be easily fitted and removed.
- There is enough clearance at the rear of the mount for the overhang of the radio.
- There is good air circulation, particularly at the rear.
- If the mounting surface is uneven, bend the tabs of the base plate to fit the surface.

Safe Installation and Operation of the Mount and Radio

Before installation or use, carefully read all instructions in this section for correct and safe installation and operation. After reading, keep this document handy for future reference. For more information on radio installation, see the installation guide for your radio, available from the Tait Support website (www.taitradio.com/support).

 **Warning** Incorrect installation of the Mount may result in death or serious injury. The mount could break loose due to the extreme forces applied during a collision or braking.

- Only install the mount to a surface or structural element and in a location that can structurally support the combined weight of the mount with either a 50W radio (4.5lbs [2kg]), or a 25 W radio (3.8lbs [1.7kg]) during a collision.
- Only use screws that are appropriate for the mounting surface's structure and composition.
- Tighten each screw securely, ensuring that the mount and radio have no loose joints after installation.
- Regularly check that the mount and radio are secure. Retighten or replace parts when necessary.

 **Warning** Install the mount and radio where they will not interfere with the deployment of air-bags, vehicle operator controls, and the vehicle operator's view.

 **Warning** When drilling holes in the vehicle, check that drilling at the selected points will not damage existing wiring, petrol tanks, fuel and brake lines, or battery cables.

 **Warning** To avoid accidental air explosions, do not use the unit around petrol, thinner, and other combustibles.

 **Warning** For continued safe operation, replace and do not reuse the Universal Mount or its components once it has been involved in a crash at speeds greater than 30mph (50km/h).

Notice When installing the radio and mount, ensure the cables are protected from engine heat, sharp edges, and from being pinched or crushed. Use appropriate cable grommets and bushings where necessary.

Installation of this product in a vehicle must be performed according to the instructions provided by the vehicle manufacturer. For more information refer to the vehicle manufacturer's website or contact the vehicle manufacturer's dealer.

Installation

Fitting the Side Brackets to the Radio

Use a 2.5 mm allen key and four screws with washers ⑤ to attach the two side brackets ④ to the screw holes at the sides of the radio.

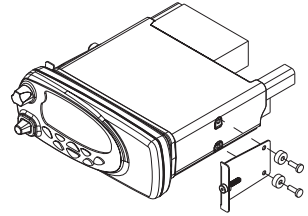

Fitting the Mount to a Surface

1 Use a Pozi #2 screwdriver or 8mm socket drive, and at least four screws ⑦ to attach the base plate ③ to the mounting surface.

Notice Do not distort the base plate. If the chosen surface is not completely flat, bend the base plate tabs as required, then secure with screws.

Notice If precise positioning is required, pre-drill \varnothing 1/8 inch (3 mm) pilot holes for the self-drilling screws. Reduce the hole size in metal that is less than 1/32 inch (1 mm) thick.

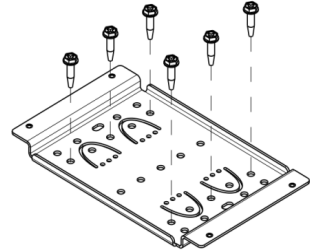

Warning When drilling holes in a vehicle, check that drilling at the selected points will not damage existing wiring, fuel tanks, fuel lines, brake pipes or battery cables.

- 2 Use a T8 Torx screwdriver and four of the eight screws ⑥ to fasten the mount body ② to the base plate ③.
- 3 Use a T8 Torx screwdriver and the four remaining screws ⑥ to fasten the lid ① to the mount body ②.

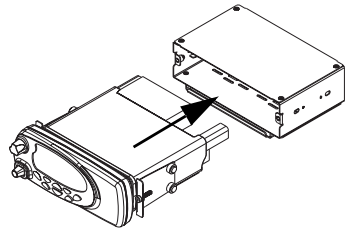

Fitting the Mount to a DIN Slot

i If the base plate **③** is attached it should be removed before fitting the mount inside the vehicle DIN slot.

- 1 Use a T8 Torx screwdriver and four of the eight screws **⑥** to fasten the lid **①** to the mount body **②**.
- 2 Slide the mount inside the DIN slot, and fit the mount using the slotted side holes (two on each side) of the mount body **②**.

i The screws for this procedure are not supplied as they will be specific to the vehicle.

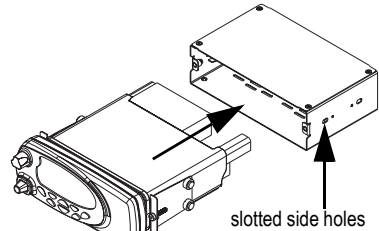

Connect the Cables

- 1 Connect the cables to the back of the radio by feeding them through from the rear of the mount body **②**.
- 2 Carefully slide the radio into the mount body **②**.

Fitting the Radio to the Mount

- 1 Align the screws on the side brackets **④** with the holes at the front of the mount body **②**.
- 2 Use a 3 mm ball nose allen key to fasten the screws **④**.

i Alternate from one side to the other while fastening the screws **④** so that the radio slides in straight.

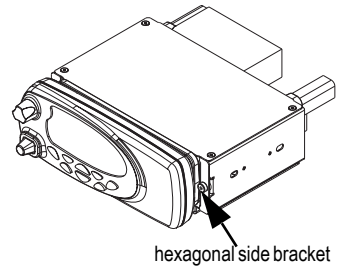

Drill Templates (not to scale)

