

TMAA03-53 Dual Body Cradle Installation Instructions

The TMAA03-53 Dual Body Cradle allows for two TM8000 and TM9000 mobile radios to be mounted on top of each other for use in dual-band or multiple radio installations.

The dual body cradle ① is supplied with:

- M4x10 thumb screws (x8) ②
- 10x20 self-drilling screws and washers (x4) ③

The following figures show the installation of two radios with the smaller control head (such as the RJ-45 control head shown) and two radios with the larger graphical control head.

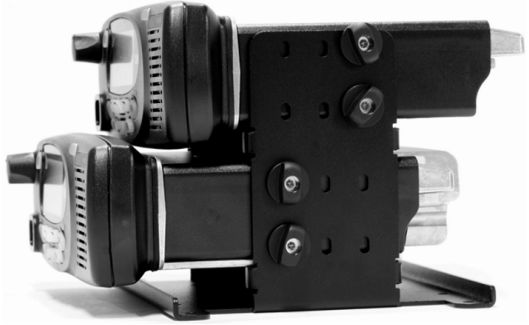

With the larger graphical control head, the radios must be mounted in an offset configuration.

The dual body cradle can also be mounted upside down.

For radios with an output power larger than 25 W (with a thicker body and requiring a larger gap for heat distribution) the mounting holes for the thumb screws are slotted.

The base plate of the dual body cradle provides a number of mounting holes with the central five holes sharing the same pattern with the TMAA03-02 Security Cradle.

Alert Symbols and Message Conventions

Please follow exactly any instruction that appears in the text as an ‘alert.’ An alert provides necessary safety information as well as instruction in the proper use of the product. This document uses the following types of alert:



Warning This alert is used when there is a hazardous situation which, if not avoided, could result in death or serious injury.



Caution This alert is used when there is a hazardous situation which, if not avoided, could result in minor or moderate injury.

Notice This alert is used to highlight information that is required to ensure procedures are performed correctly. Incorrectly performed procedures could result in equipment damage or malfunction.

Notice Risk of overheating! For radios with an output power larger than 25W (with a thicker body and requiring a larger gap for heat distribution) move the top radio up and the bottom radio down within the slotted thumb screw holes.



This alert is used to highlight significant information that may be required to ensure procedures are performed correctly, or to draw your attention to ways of doing things that can improve your efficiency or effectiveness.

Safe Mounting and Operation of the Cradle and Radios

Before installation or use, be sure to carefully read all the instructions in this section for correct and safe installation and operation. After reading, keep this document handy for future reference. For more information on radio installation, see the installation guide for your radio available from the Tait Support website (www.taitradio.com/support).



Warning Incorrect installation of the cradle may result in death or serious injury. The cradle could break loose due to the extreme forces applied during a collision or braking.

- Install the cradle only to a mounting surface or structural element and in a location that can structurally support the weight of the cradle and the radios (6.6lbs [3kgs]) during a collision.
- Use nuts and bolts that are appropriate for the mounting surface’s structure and composition.
- Tighten each nut and bolt securely. Ensure that the cradle and the radios have no loose joints after installation.
- Check regularly whether the cradle and the radios are still secure. Retighten or replace if necessary.



Warning When mounting the cradle inside a vehicle, make sure to mount it securely. Unsecured equipment is dangerous to the vehicle occupants.



Warning Choose a mounting position for the cradle where it will not interfere with the operation of any of the vehicle controls.



Warning Do not mount the radio vertically, with the control head facing down. This will violate compliance with the standards UL/CSA/EN 60950, Safety of Information Technology Equipment.



Warning When drilling holes in the vehicle, check that drilling at the selected points will not damage existing wiring, petrol tanks, fuel and brake lines, or battery cables.



Warning To avoid accidental air explosions, do not use the unit around gasoline, thinner or other combustibles.

Notice When installing the cradle and radios, make sure the cables are protected from engine heat, sharp edges and from being pinched or crushed. Use appropriate cable grommets.



Installation of this product on a vehicle must be performed according to the instructions provided by the vehicle manufacturer. For more information, refer to the vehicle manufacturer's website or contact the vehicle manufacturer's dealer.

Drill Pattern

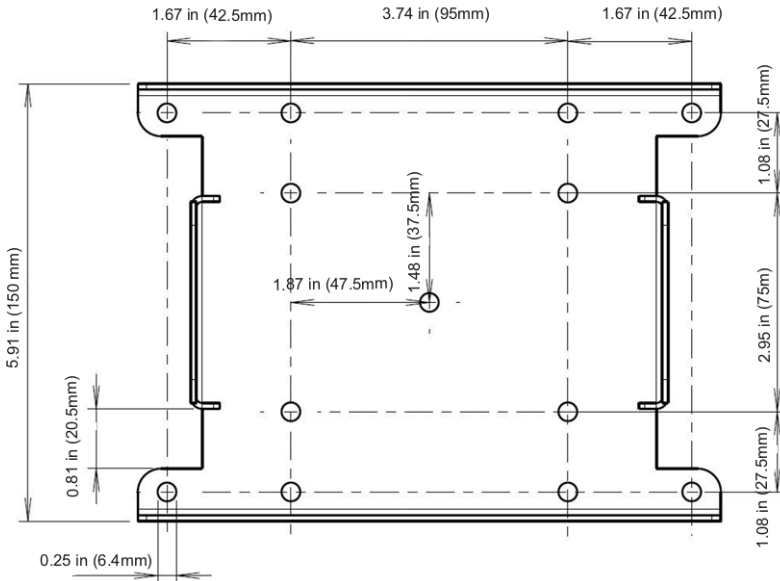

The four outer mounting holes allow for the radios to remain mounted to the cradle.

Selecting the Mounting Position



Warning When mounting the cradle inside a vehicle, make sure to mount it securely. Unsecured equipment is dangerous to the vehicle occupants.

Before installing the Dual Torso Cradle, make sure that the site you have chosen for the installation meets the following criteria:

- The site has enough height for the radios to be easily fitted and removed.
- The site has enough depth for the radios. Check that the front and rear overhang of the radios will fit where you are mounting the cradle.
- The site allows for good air circulation, particularly at the rear of the radios.

Mounting the Cradle



The base plate of the dual body cradle provides a number of mounting holes with the central five holes sharing the same pattern with the TMAA03-02 Security Cradle.



Warning When drilling holes in the vehicle, check that drilling at the selected points will not damage existing wiring, petrol tanks, fuel and brake lines, or battery cables.

Notice When mounting the cradle, check whether the mounting surface needs to be reinforced.



The four outer mounting holes allow for the radios to remain mounted to the cradle during mounting and removal.

1. Drill any holes required for cables and install suitable grommets or bushings in the holes.
2. Screw the cradle base in the chosen mounting position using the four self-drilling screws and washers provided.

Notice Risk of overheating! For radios with an output power larger than 25W (with a thicker body and requiring a larger gap for heat distribution) move the top radio up and the bottom radio down within the slotted thumb screw holes.

3. Slide the radios into the cradle tabs and then secure the radios using the thumb screws.

More Information

Refer to your radio provider for more information about this product.